

Shut off Valve - Sub-plate mounting, Model : MSSL06-2.0



the right connection

Ref. No : H02651, Release Jan 2006 (Dimensions in mm)

Description

Shut off valves model MSSL06-2.0 are rising spindle, seat type valves with metal to metal seat for leak-free closure between it's port 'A' and port 'B'.

The mounting interface conforms to ISO 5781 - AB - 03 - 4 - B.



Section

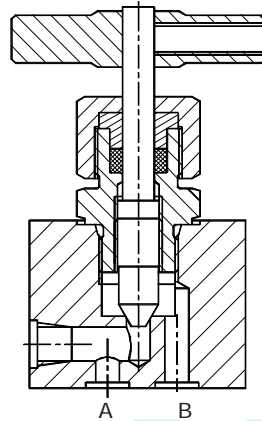

Hydraulic Symbol

Unit Dimensions

Valve

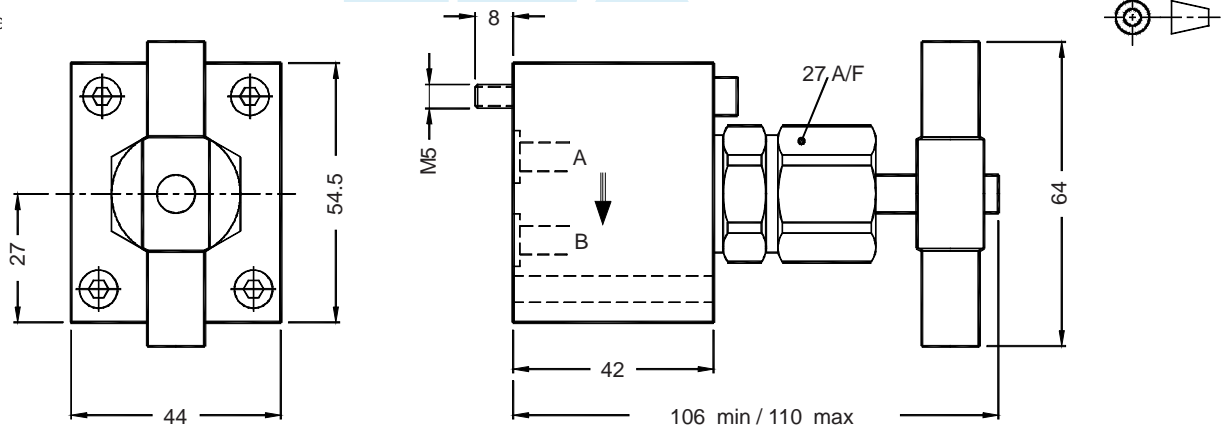

Note : Valve fixing screws : M5 x 50 L, (10.9) 4 nos.
Tightening torque : 9 Nm

Interface - as per ISO 5781 - AB - 03 - 4 - B standard

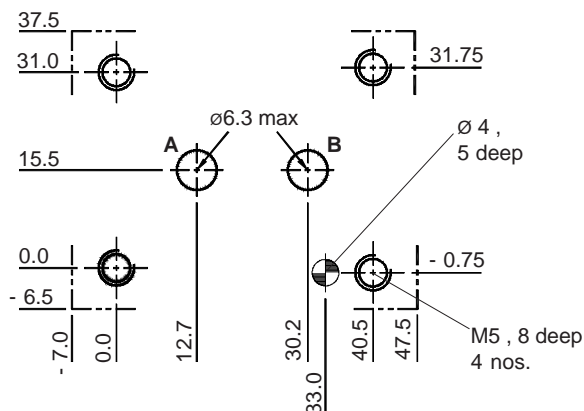

Mounting Surface roughness : 0.8 μm
Mounting Surface flatness : 0.01 $\mu\text{m}/100\text{ mm}$

Shut off Valve - Sub-plate mounting, Model : MSSL06-2.0



the right connection

Ref. No : H02651, Release Jan 2006 (Dimensions in mm)

Technical Specifications

- Construction Seat type.
- Mounting type Sub-plate mounting type.
- Interface ISO 5781 - AB - 03 - 4 - B.
- Mounting position Optional
- Flow direction From port `A' to port `B'.
- Operating pressure 315 bar.
- Hydraulic medium Mineral oil.
- Viscosity range 10 cSt to 380 cSt.
- Fluid temperature range -20 °C to +80 °C.
- Fluid cleanliness requirement As per ISO 19/16 or better.
- Mass 0.9 kg.
- Maximum flow handling capacity Refer graph.

Performance Curves

- Oil used : ISO VG 68,
- Viscosity : 68 cSt @ 40 °C
- Test conducted at : 50 °C.

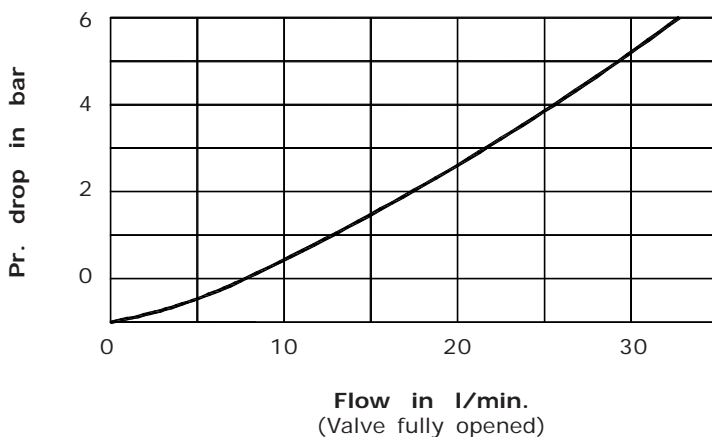

Ordering Code

