

## QUICK COUPLER Series WQ

Cat No WQ - 01 - 01

### QUICK COUPLER - 5NW, 8NW

#### Features

- Nickel plated brass body
- High flow characteristics
- Wide range of models
- Maintenance free and long life
- Compact size
- Attractive design
- Teflon pre-coated male taper threads



#### Application

This can be effectively used in all compressed air line applications  
Some of them include

- All compressed air lines
- Assembly lines with pneumatic tools / Machinery with pneumatic systems
- Pneumatic control panels

#### Operation

To connect the coupling, simply push the plug into the coupling.

To disconnect the coupling, push the sleeve back and the plug automatically comes out.

#### Safety precautionary note

During disconnecting under pressure, the plug comes out with high speed and force. Hence care to be taken to prevent injury.

#### Technical Specifications

Model No	Socket	WQC03...	WQC14...
	Plug	WQP03...	WQP14...
NW		5	8
Thread		1/4	1/2
Medium		Air	
Working Pressure range		0 - 10 bar	
Ambient / Medium temperature		5° - 60° C	
Flow (lpm)		1000	2250
Coupling load at 10 bar (kgf)		13	15
Materials of construction		Brass, Stainless steel, Nitrile & Acetal	

# QUICK COUPLER

## Series WQ

Cat No WQ - 01 - 01

### MODEL WQC03 ( NW - Ø5 )

#### Socket

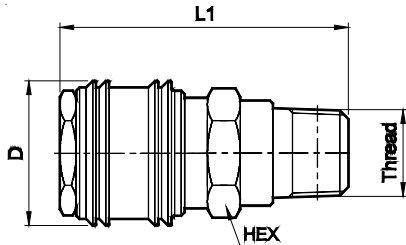

Thread	D	L1	HEX	Ordering No
R1/4	22	44	17	WQC03M51

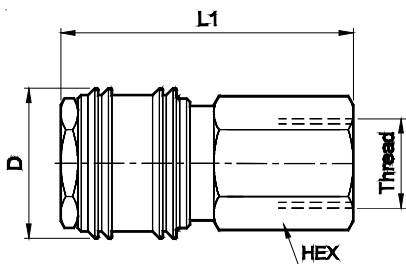

Thread	D	L1	HEX	Ordering No
G1/4	22	43	17	WQC03F61

### MODEL WQP03

#### Plug

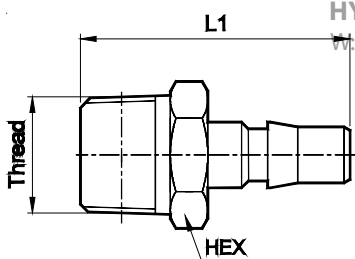

Thread	ØD	L1	HEX	Ordering No
R1/4	-	36.5	14	WQP03M51

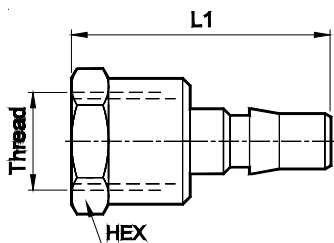

Thread	ØD	L1	HEX	Ordering No
G1/4	-	35	17	WQP03F61

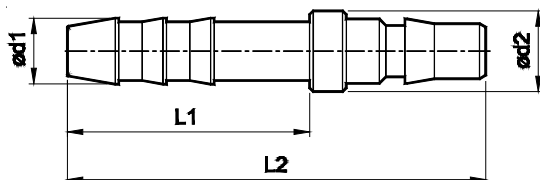

Applicable Hose OD	Ød1	Ød2	L1	L2	Ordering No
Ø8	9	11	33	57	WQP03T08

# QUICK COUPLER

## Series WQ

Cat No WQ - 01 - 01

### MODEL WQC14 ( NW - Ø8 )

#### Socket

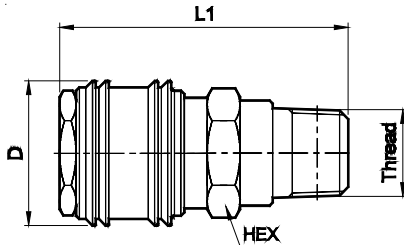

Thread	ØD	L1	HEX	Ordering No
R1/2	27.5	48.5	22	WQC14M53

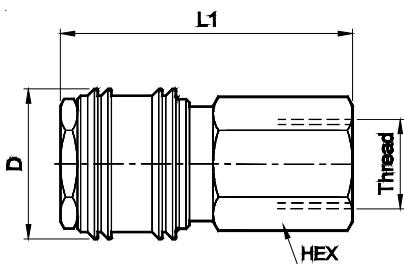

Thread	ØD	L1	HEX	Ordering No
G1/2	27.5	57	24	WQC14F63

### MODEL WQP14

#### Plug

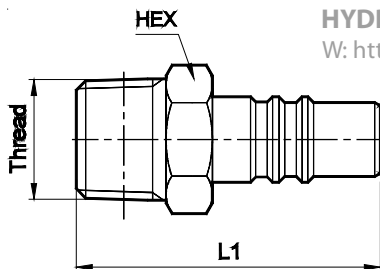

Thread	ØD	L1	HEX	Ordering No
R1/2	-	48	22	WQP14M53

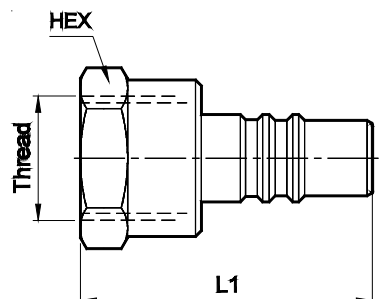

Thread	ØD	L1	HEX	Ordering No
G1/2	-	45	27	WQP14F63

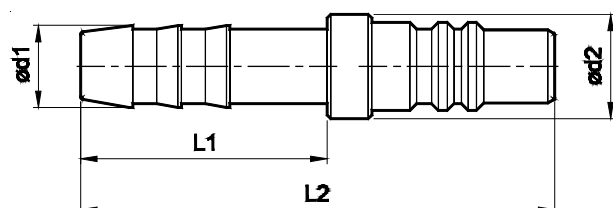

Applicable Hose OD	Ød1	Ød2	L1	L2	Ordering No
Ø10	11	14	33	63.5	WQP14T10

Subject to change